



Conex   Bänninger Conex Compression	Conex   Bänninger >B< Press	Conex   Bänninger >B< Press Carbon	Conex   Bänninger Push-Fit	Conex   Bänninger >B< Oyster	Conex   Bänninger Series 3000
Conex   Bänninger Triflow Solder Ring	Conex   Bänninger >B< Press Gas	Conex   Bänninger >B< Press Inox	Conex   Bänninger Cuprofit	Conex   Bänninger Medical Gas	Conex   Bänninger Series 8000
Conex   Bänninger Delcop End Feed	Conex   Bänninger >B< Press Solar	Conex   Bänninger >B< Flex	Conex   Bänninger <b>K65</b>	Conex   Bänninger OEM	Conex   Bänninger Series 8000 M
Conex   Bänninger Delbraze	Conex   Bänninger >B< Press XL	Conex   Bänninger >B< Push	Conex   Bänninger Valves	Conex   Bänninger >B< ACR	



Gate Valves Range

United Kingdom  
Conex Universal Limited

Germany  
IBP GmbH

Tel: +44 (0)121 557 2831 | Fax: +44 (0)121 557 0185 | Email: [sales@ibpgroup.com](mailto:sales@ibpgroup.com) | Website: [www.conexbanninger.com](http://www.conexbanninger.com)

Spain/France  
IBP Atcosa SL

Italy  
IBP Banninger Italia srl

Poland Sales, Marketing and Logistics  
IBP Instal fittings Sp z o.o.

China  
IBP China

The content of this publication is for general information only. It is the user's responsibility to determine suitability of any product for the purpose intended and reference should be made to our Technical Department if clarification is required. In the interests of technical development we reserve the right to change specification, design and materials without notice.

Conex Bänninger products are approved by numerous Standards Authorities and Certification Bodies. For more details on this product range, please email our technical team at: [technical@ibpgroup.com](mailto:technical@ibpgroup.com). IBP trade marks are registered in numerous countries.

## Conex Bänninger Gate Valves

Conex Bänninger Gate Valves are used for permitting or preventing flow and are best used in systems that require infrequent use of the valve. When fully open, full flow occurs, giving minimal resistance or pressure drop.

### Non-rising stem

Conex Bänninger Gate Valves are designed with non-rising stems making them ideal for use in applications where vertical space is limited.

### Materials

This comprehensive range of Gate Valves from Conex Bänninger is manufactured from high quality brass, DZR brass and bronze (red brass) which has excellent resistance to corrosion.

### Durable and reliable

Gate Valves are durable and extremely reliable in use. Gate Valves open or close relatively slowly and will open or close fully when they have not been operated over a prolonged period of time. This makes them the preferred choice for isolation applications where pressure surges (hydraulic shock) should be avoided and where the valve is used infrequently.

### Applications

All Conex Bänninger Gate Valves can be used in systems involving the supply of drinking water, whilst the DZR brass and bronze valves are suitable for low temperature hot water and chilled systems. All valves in the range are WRAS approved.

### Quality assurance

Conex Universal Ltd is an ISO 9001 Quality Assured company registered with the BSI.

### 5-year warranty

When professionally fitted and in accordance with the installation instructions, Conex Banninger Valves are guaranteed against manufacturing defects for five years from first purchase date. Any alleged defects must be reported to Conex Universal Ltd within one month of the first occurrence, clearly setting out the nature of the claim. The warranty is limited to the repair and replacement of defective fittings at the discretion of Conex Universal Ltd and the company reserves the right to inspect and test the alleged defects. This warranty provided by Conex Universal Ltd does not affect your statutory rights. For more information about installation visit [www.conexbanninger.com](http://www.conexbanninger.com).

### General information

Performance data, including pressure-temperature ratings have been developed from published standards, supplier material specifications, design calculations and in-house testing. They cover typical applications for the Conex Bänninger Gate Valve product range and are provided as a general guideline.

For specific applications, users are advised to contact Conex Bänninger for technical advice. Failure to follow advised installation instructions may result in damage and personal injury for which Conex Universal Ltd cannot be held liable.

## Contents

1120 Gate Valve Handwheel - PN20 - Light Pattern - (Brass) .....	1
1121 Gate Valve Handwheel - PN20 - (Bronze) .....	3
1121 Gate Valve Lockshield - PN20 - (Bronze) .....	5
1122 Gate Valve Handwheel - PN20 - (Brass) .....	7
1122 Gate Valve Lockshield - PN20 - (Brass).....	9
1124 Gate Valve Handwheel - PN20 - (DZR) .....	11
1124 Gate Valve Lockshield - PN20 - (DZR) .....	13
1126 Gate Valve Handwheel - PN32 - (Bronze) .....	15

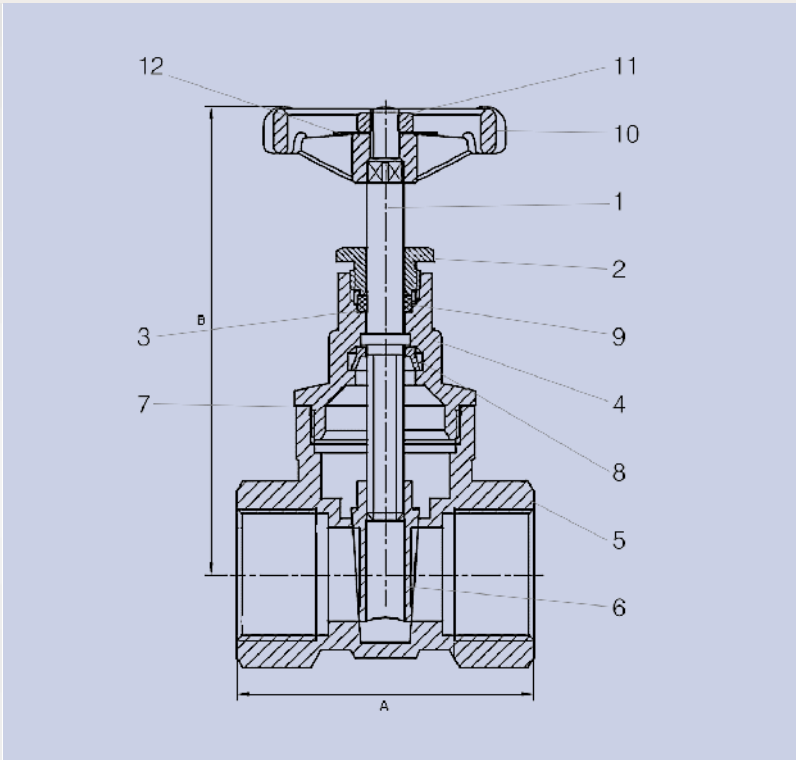

Features and benefits:

- Non-rising stem.
- Designed in accordance with EN 12288 requirements.
- High quality brass construction.
- End connections, female taper threads to EN 10226-2 (ISO 7-1).
- WRAS approved for drinking water.
- Suitable for low temperature hot water systems.
- Not suitable for high temperature working, temperatures above 100°C.
- Unique Conex Bänninger handwheel.

Gate Valve - 1120

Order Code BS EN 10226 (ISO 7-1) thread	Size	DN	A	B	Kv Value	Weight (kg)
112010RRW200404	1/2"	15	48	70	17	0.25
112010RRW200606	3/4"	20	50	80	32	0.39
112010RRW200808	1"	25	60	90	52	0.58
112010RRW201010	1 1/4"	32	64	115	102	0.98
112010RRW201212	1 1/2"	40	69	125	170	1.10
112010RRW201616	2"	50	81	155	224	1.80

Valve suitability

Product	Steam	Water	Drinking Water	Oil	Air (Oil Free)	Gas (Inert)	Gas (Combustible)	Gas (Corrosive)	Gas (Oxygen)
1120	x	✓	✓	✓	x	x	x	x	x

Max. working parameters

1120	Temperature °C	Pressure bar	Pressure psi
Water	-10 to +100	20	290

Valves range

1120 Gate Valve Handwheel - PN20 - Light Pattern - (Brass)

Material specification

Handwheel version: 1120 - 1/2" - 2"

No	Component	Material	Specification
1	Stem	Brass	EN 12164 CW617N-DW
2	Packing Nut	Brass	EN 12164 CW614N
3	Packing	PTFE	PTFE
4	Bonnet	Brass	EN 12165 CW617N-DW
5	Body	Brass	EN 12165 CW617N-DW
6	Wedge	Brass	EN 12165 CW617N-DW
7	Seal	PTFE	PTFE
8	Stem Retainer	DZR Brass	EN 12164 CW602N
9	Packing Ring	Brass	EN 12164 CW614N
10	Handwheel	Aluminium	EN 1706 LM6
11	Handwheel Nut	Brass	EN 12164 CW614N
12	Identity Disc	Aluminium	EN 1706 LM6

Gate Valves are designed for services that only need infrequent operation, where the gate is maintained at either fully open or fully closed. They should not be used for throttling the flow of fluid.

Specification clauses:

Designed in accordance with EN 12288 requirements.

Non-rising stem.

Handwheel operated.

Brass threaded bonnet and one piece wedge.

End connections, female taper threads to EN 10226-2 (ISO 7-1).

WRAS approved for drinking water systems.

Suitable for low temperature hot water systems.

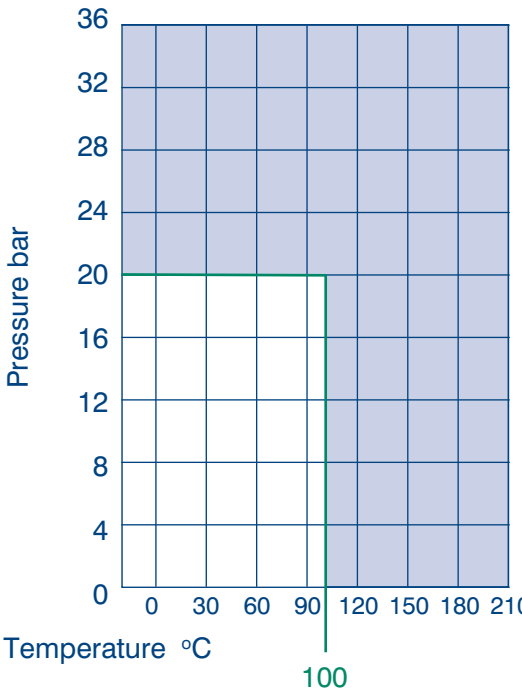



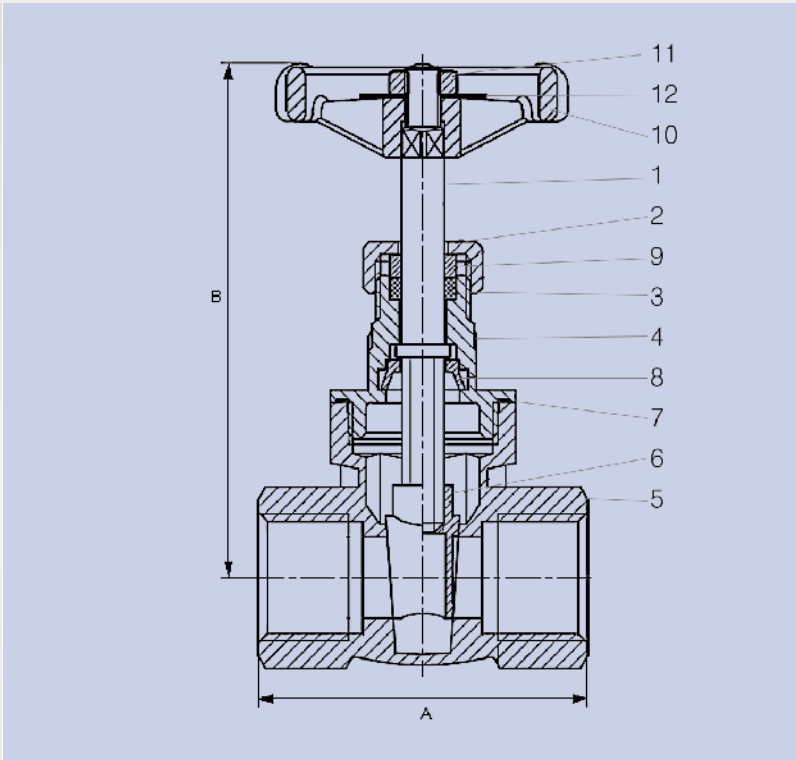

Features and benefits:

- Designed in accordance to EN 12288 requirements.
- High quality bronze construction immune to dezincification and stress corrosion cracking resistant.
- Robust construction ensures reliable in-process service.
- Bronze material in accordance with EN 1982.
- End connections, female taper threads EN 10226-2 (ISO 7-1).
- WRAS approved for drinking water applications.
- Suitable for use with low temperature hot water and chilled systems.
- Unique Conex Bänninger handwheel.

Gate Valve - 1121

Order Code EN 10226-2 (ISO 7-1) thread	Size	DN	A	B	Kv Value	Weight (kg)
112120RRW200404	1/2"	15	55	85	16	0.32
112120RRW200606	3/4"	20	60	95	32	0.41
112120RRW200808	1"	25	65	115	52	0.63
112120RRW201010	1 1/4"	32	75	125	100	1.03
112120RRW201212	1 1/2"	40	80	145	172	1.40
112120RRW201616	2"	50	90	165	230	1.94
112120RRW202020*	2 1/2"	65	100	210	-	3.68
112120RRW202424*	3"	80	115	240	-	5.42
112120RRW203232*	4"	100	135	290	-	10.59

\*Valves available to special order.

Valve suitability

Product	Steam	Water	Drinking Water	Oil	Air (Oil Free)	Gas (Inert)	Gas (Combustible)	Gas (Corrosive)	Gas (Oxygen)
1121	x	✓	✓	✓	x	x	x	x	x

Max. working parameters

1121	Temperature °C	Pressure bar	Pressure psi
Water	-10 to +100	20	290

Specification clauses:

- Designed in accordance to EN 12288 requirements.
- Bronze material in accordance with EN 1982.
- High quality bronze construction immune to dezincification and stress corrosion cracking resistant.
- Non-rising stem.
- Handwheel operated.
- Bronze threaded bonnet and one piece wedge.
- End connections, female taper threads to EN 10226-2 (ISO 7-1).
- WRAS approved for drinking water systems.
- Suitable for low temperature hot water and chilled systems.

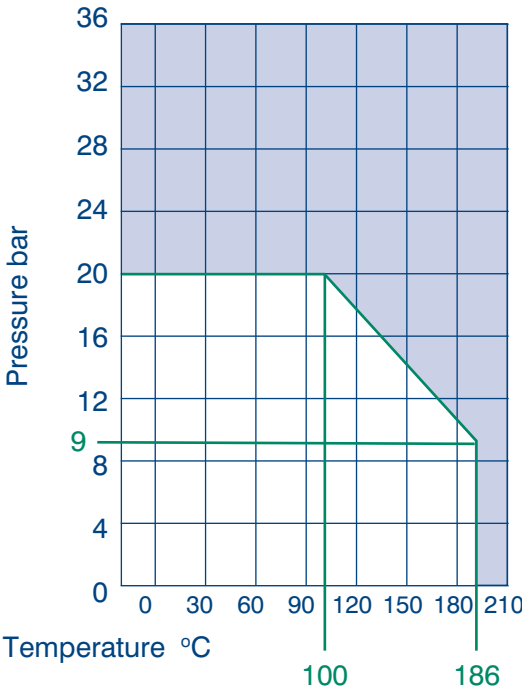

Valves range  
1121 Gate Valve Handwheel - PN20 - (Bronze)

Material specification

Handwheel version: 1121 - 1/2" - 4"

No	Component	Material	Specification
1	Stem	Bronze	EN 1982 CC491K
2	Packing Nut	Brass	EN 12164 CW614N
3	Packing	PTFE	PTFE
4	Bonnet	Bronze	EN 1982 CC491K
5	Body	Bronze	EN 1982 CC491K
6	Wedge	Bronze	EN 1982 CC491K
7	Seal	PTFE	PTFE
8	Stem Retainer	DZR Brass	EN 12164 CW602N
9	Packing Ring	Brass	EN 12164 CW614N
10	Handwheel	Aluminium	EN 1706 LM6
11	Handwheel Nut	Brass	EN 12164 CW614N
12	Identity Disc	Aluminium	EN 1706 LM6

Gate Valves are designed for services that only need infrequent operation, where the gate is maintained at either fully open or fully closed. They should not be used for throttling the flow of fluid.

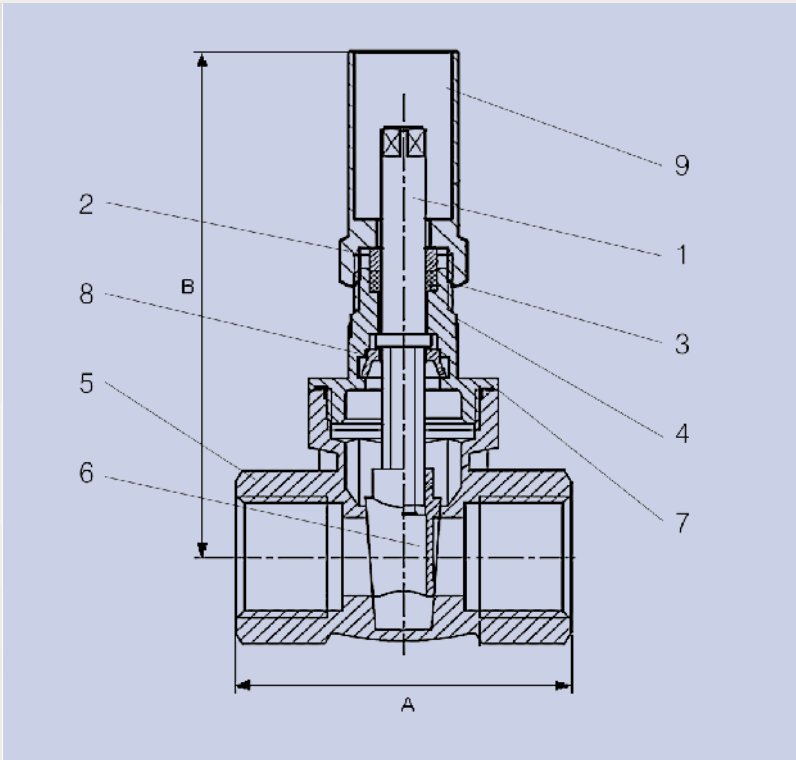

Features and benefits:

- Designed in accordance to EN 12288 requirements.
- High quality bronze construction immune to dezincification and stress corrosion cracking resistant.
- Bronze material in accordance with EN 1982.
- Lockshield key operated.
- End connections, female taper threads to EN 10226-2 (ISO 7-1).
- WRAS approved for drinking water systems.
- Suitable for use with low temperature hot water and chilled systems.

Gate Valve - 1121

Order Code EN 10226-2 (ISO 7-1) thread	Size	DN	A	B	Kv Value	Weight (kg)
112120RRK200404	½"	15	55	85	16	0.32
112120RRK200606	¾"	20	60	95	32	0.41
112120RRK200808	1"	25	65	110	52	0.63
112120RRK201010	1¼"	32	75	125	100	1.03
112120RRK201212	1½"	40	80	145	172	1.40
112120RRK201616	2"	50	90	170	230	1.94
112120RRK202020*	2½"	65	100	210	-	3.68
112120RRK202424*	3"	80	115	240	-	5.42
112120RRK203232*	4"	100	135	290	-	10.59

\*Valves available to special order.

A--GVLKKEY-- Lockshield key for valves ½" to 1"

B--GVLKKEY-- Lockshield key for valves 1¼" to 2"

Valve suitability

Product	Steam	Water	Drinking Water	Oil	Air (Oil Free)	Gas (Inert)	Gas (Combustible)	Gas (Corrosive)	Gas (Oxygen)
1121	x	✓	✓	✓	x	x	x	x	x

Max. working parameters

1121	Temperature °C	Pressure bar	Pressure psi
Water	-10 to +100	20	290

Specification clauses:

- Bronze material in accordance to EN 1982.
- High quality bronze construction immune to dezincification and stress corrosion cracking resistant.
- Bronze threaded bonnet and one piece wedge.
- Non-rising stem.
- Designed in accordance with EN 12288 requirements.
- End connections, female taper threads to EN 10226-2 (ISO 7-1).
- Lockshield key operated.
- WRAS approved for drinking water systems.
- Suitable for use with low temperature hot water and chilled systems.

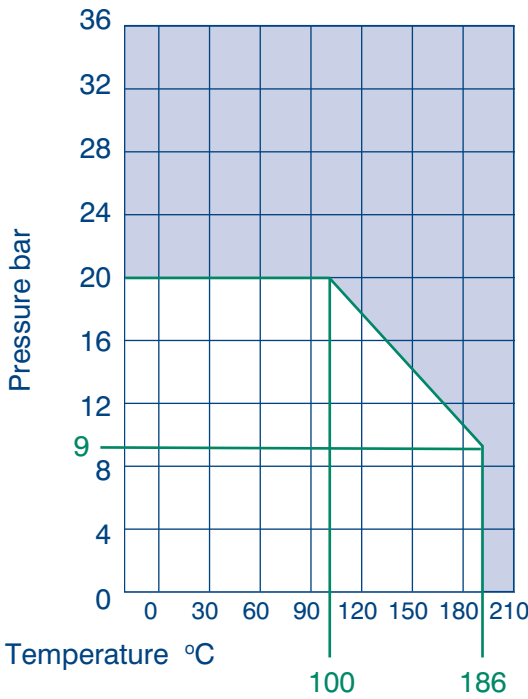

Valves range  
1121 Gate Valve Lockshield - PN20 - (Bronze)

Material specification

Lockshield version: 1121 - ½" - 4"

No	Component	Material	Specification
1	Stem	Bronze	EN 1982 CC491K
2	Packing Nut	Brass	EN 12165 CW614N
3	Packing	PTFE	PTFE
4	Bonnet	Bronze	EN 1982 CC491K
5	Body	Bronze	EN 1982 CC491K
6	Wedge	Bronze	EN 1982 CC491K
7	Seal	PTFE	PTFE
8	Stem Retainer	DZR Brass	EN 12165 CW602N
9	Lockshield	Brass	EN 12164 CW614N

Gate Valves are designed for services that only need infrequent operation, where the gate is maintained at either fully open or fully closed. They should not be used for throttling the flow of fluid.

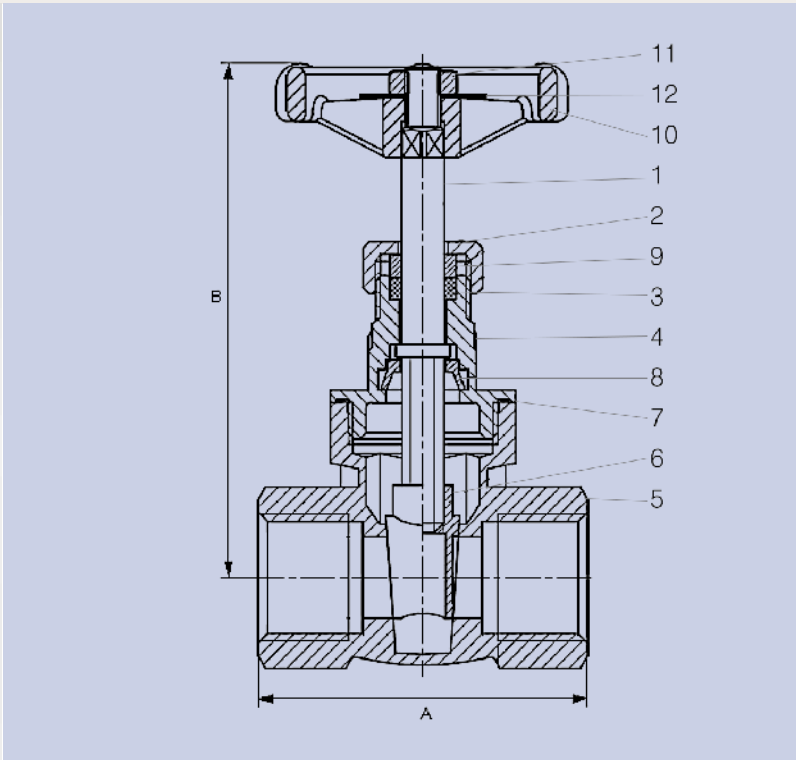

Features and benefits:

- Kitemark approved to EN 12288.
- High quality brass construction.
- Non-rising stem.
- End connections, female taper threads to EN 10226-2 (ISO 7-1).
- WRAS approved for drinking water systems.
- Suitable for low temperature hot water systems.
- Unique Conex Bänninger handwheel.

Gate Valve - 1122

Order Code EN 10226-2 (ISO 7-1) thread	Size	DN	A	B	Kv Value	Weight (kg)
112210RRW200404	1/2"	15	55	85	16	0.28
112210RRW200606	3/4"	20	60	95	32	0.40
112210RRW200808	1"	25	70	115	52	0.57
112210RRW201010	1 1/4"	32	75	125	100	0.96
112210RRW201212	1 1/2"	40	80	145	172	1.13
112210RRW201616	2"	50	90	165	230	1.9
112210RRW202020*	2 1/2"	65	100	210	-	3.07
112210RRW202424*	3"	80	115	240	-	4.40
112210RRW203232*	4"	100	135	290	-	7.95

\*Valves available to special order.

Valve suitability

Product	Steam	Water	Drinking Water	Oil	Air (Oil Free)	Gas (Inert)	Gas (Combustible)	Gas (Corrosive)	Gas (Oxygen)
1122	x	✓	✓	✓	x	x	x	x	x

Max. working parameters

1122	Temperature °C	Pressure bar	Pressure psi
Water	-10 to +100	20	290

Valves range

1122 Gate Valve Handwheel - PN20 - (Brass)

Material specification

Handwheel version: 1122 - 1/2" - 4"

No	Component	Material	Specification
1	Stem	Brass	EN 12164 CW617N-DW
2	Packing Nut	Brass	EN 12164 CW614N
3	Packing	PTFE	PTFE
4	Bonnet	Brass	EN 12165 CW617N-DW
5	Body	Brass	EN 12165 CW617N-DW
6	Wedge	Brass	EN 12165 CW617N-DW
7	Seal	PTFE	PTFE
8	Stem Retainer	DZR Brass	EN 12164 CW602N
9	Packing Ring	Brass	EN 12164 CW614N
10	Handwheel	Aluminium	EN 1706 LM6
11	Handwheel Nut	Brass	EN 12164 CW614N
12	Identity Disc	Aluminium	EN 1706 LM6

Gate Valves are designed for services that only need infrequent operation, where the gate is maintained at either fully open or fully closed. They should not be used for throttling the flow of fluid.

Specification clauses:

- Kitemark approved to EN 12288.
- Handwheel operated.
- Non-rising stem.
- Brass threaded bonnet and one piece wedge.
- End connections, female taper threads to EN 10226-2 (ISO 7-1).
- WRAS approved for drinking water systems.
- Suitable for low temperature hot water systems.

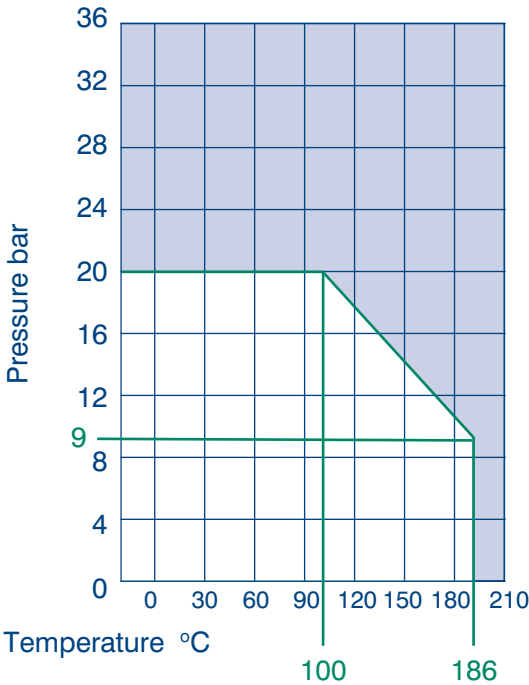

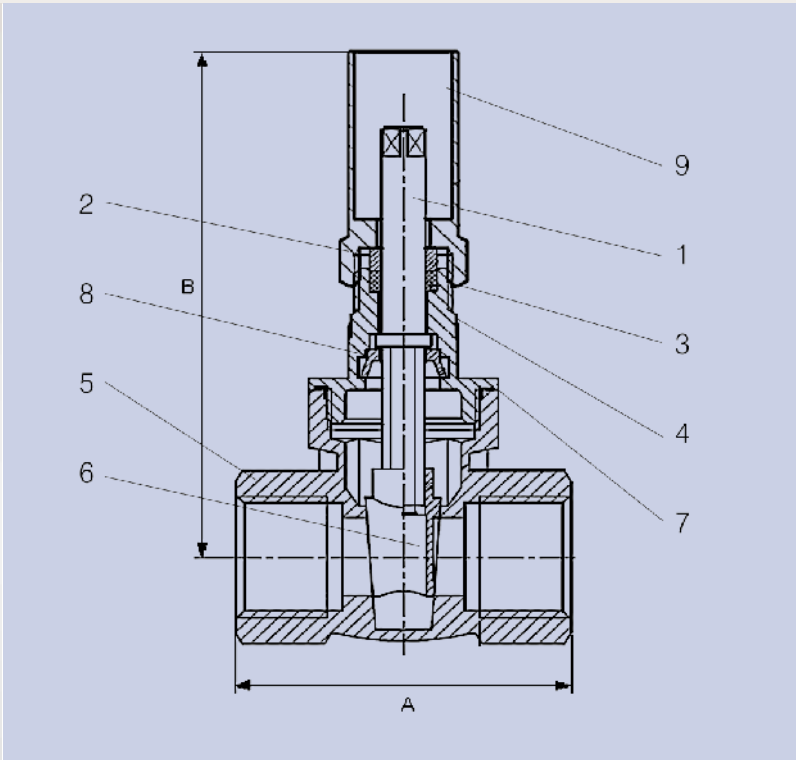

Features and benefits:

- Kitemark approved to EN 12288.
- Non-rising stem.
- Lockshield key operated.
- End connections, female taper threads designed to EN 10226-2 (ISO 7-1).
- WRAS approved for drinking water systems.
- Suitable for low temperature hot water systems.

Gate Valve - 1122

Order Code EN 10226-2 (ISO 7-1) thread	Size	DN	A	B	Kv Value	Weight (kg)
112210RRK200404	½"	15	55	85	16	0.26
112210RRK200606	¾"	20	60	95	32	0.40
112210RRK200808	1"	25	65	110	52	0.57
112210RRK201010	1¼"	32	75	125	100	0.95
112210RRK201212	1½"	40	80	145	172	1.12
112210RRK201616	2"	50	90	170	230	1.80
112210RRK202020*	2½"	65	100	210	-	2.83
112210RRK202424*	3"	80	115	240	-	4.15
112210RRK203232*	4"	100	135	290	-	7.43

\*Valves available to special order.

A--GVLKKEY-- Lockshield key for valves ½" to 1"

B--GVLKKEY-- Lockshield key for valves 1¼" to 2"

Valve suitability

Product	Steam	Water	Drinking Water	Oil	Air (Oil Free)	Gas (Inert)	Gas (Combustible)	Gas (Corrosive)	Gas (Oxygen)
1122	x	✓	✓	✓	x	x	x	x	x

Max. working parameters

1122	Temperature °C	Pressure bar	Pressure psi
Water	-10 to +100	20	290

Specification clauses:

- Kitemark approved to EN 12288.
- Non-rising stem.
- Lockshield key operated.
- Brass threaded bonnet and one piece wedge.
- End connections, female taper threads to EN 10226-2 (ISO 7-1).
- WRAS approved for drinking water systems.
- Suitable for low temperature hot water systems.

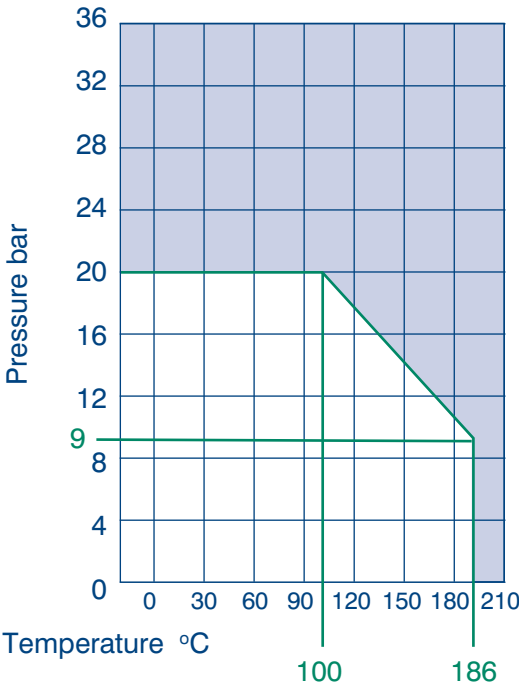

Valves range  
1122 Gate Valve Lockshield - PN20 - (Brass)

Material specification

Lockshield version: 1122 - ½" - 4"

No	Component	Material	Specification
1	Stem	Brass	EN 12164 CW617N-DW
2	Packing Nut	Brass	EN 12164 CW614N
3	Packing	PTFE	PTFE
4	Bonnet	Brass	EN 12165 CW617N-DW
5	Body	Brass	EN 12165 CW617N-DW
6	Wedge	Brass	EN 12165 CW617N-DW
7	Seal	PTFE	PTFE
8	Stem Retainer	DZR Brass	EN 12164 CW602N-DW
9	Lockshield	Brass	EN 12164 CW614N

Gate Valves are designed for services that only need infrequent operation, where the gate is maintained at either fully open or fully closed. They should not be used for throttling the flow of fluid.



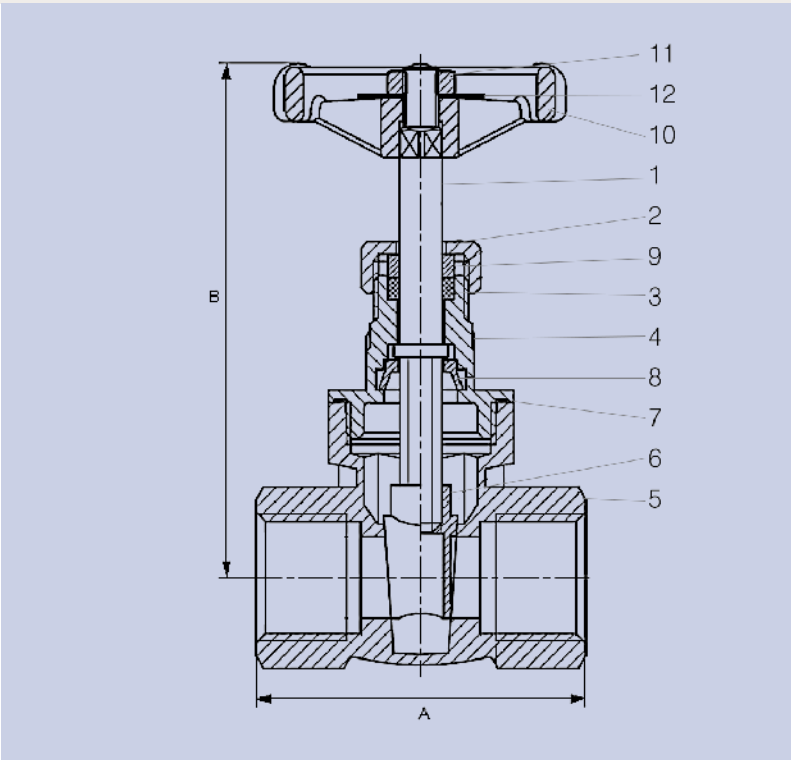

Features and benefits:

- Kitemark approved to EN 12288.
- Dezincification resistant brass construction prevents system corrosion and limits fungal growth.
- End connections, female taper threads to EN 10226-2 (ISO 7-1).
- WRAS approved for drinking water systems.
- Suitable for use with low temperature hot water and chilled systems.
- Unique Conex Bänninger handwheel.

Gate Valve - 1124

Order Code EN 10226-2 (ISO 7-1) thread	Size	DN	A	B	Kv Value	Weight (kg)
112450RRW200404	1/2"	15	55	85	16	0.26
112450RRW200606	3/4"	20	60	95	32	0.41
112450RRW200808	1"	25	65	115	52	0.61
112450RRW201010	1 1/4"	32	75	125	100	1.01
112450RRW201212	1 1/2"	40	80	145	172	1.16
112450RRW201616	2"	50	90	165	230	1.90
112450RRW202020*	2 1/2"	65	100	210	-	3.68
112450RRW202424*	3"	80	115	240	-	5.42
112450RRW203232*	4"	100	135	290	-	10.59

\*Valves available to special order.

Valve suitability

Product	Steam	Water	Drinking Water	Oil	Air (Oil Free)	Gas (Inert)	Gas (Combustible)	Gas (Corrosive)	Gas (Oxygen)
1124	x	✓	✓	✓	x	x	x	x	x

Max. working parameters

1124	Temperature °C	Pressure bar	Pressure psi
Water	-10 to +100	20	290

Specification clauses:

- Kitemark approved to EN 12288.
- DZR brass gate valve.
- Non-rising stem.
- Handwheel operated.
- DZR brass threaded bonnet and one piece wedge.
- End connections, female taper threads to EN 10226-2 (ISO 7-1).
- WRAS approved for drinking water systems.
- Suitable for low temperature hot water and chilled systems.

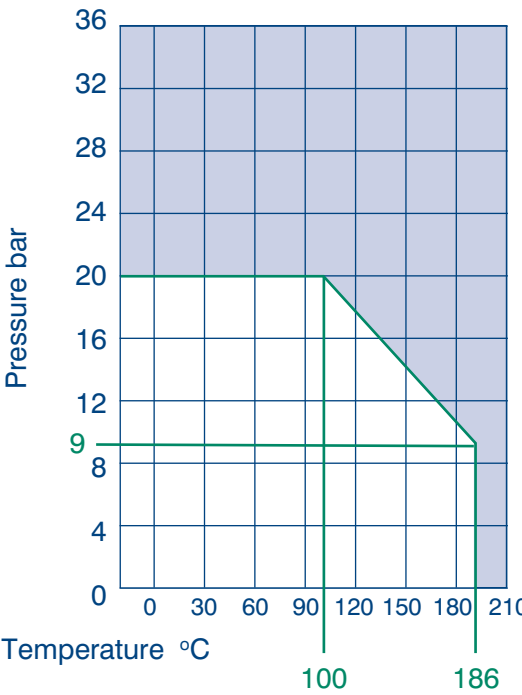

Valves range  
1124 Gate Valve Handwheel - PN20 - (DZR)

Material specification

Handwheel version: 1124 - 1/2" - 4"

No	Component	Material	Specification
1	Stem	DZR Brass	EN 12164 CW602N
2	Packing Nut	Brass	EN 12164 CW614N
3	Packing	PTFE	PTFE
4	Bonnet	DZR Brass	EN 12165CW602N
5	Body	DZR Brass	EN 12165 CW602N
6	Wedge	DZR Brass	EN 12165 CW602N
7	Seal	PTFE	PTFE
8	Stem Retainer	DZR Brass	EN 12164 CW602N
9	Packing Ring	Brass	EN 12164 CW614N
10	Handwheel	Aluminium	EN 1706 LM6
11	Handwheel Nut	Brass	EN 12164 CW614N
12	Identity Disc	Aluminium	EN 1706 LM6

Gate Valves are designed for services that only need infrequent operation, where the gate is maintained at either fully open or fully closed. They should not be used for throttling the flow of fluid.



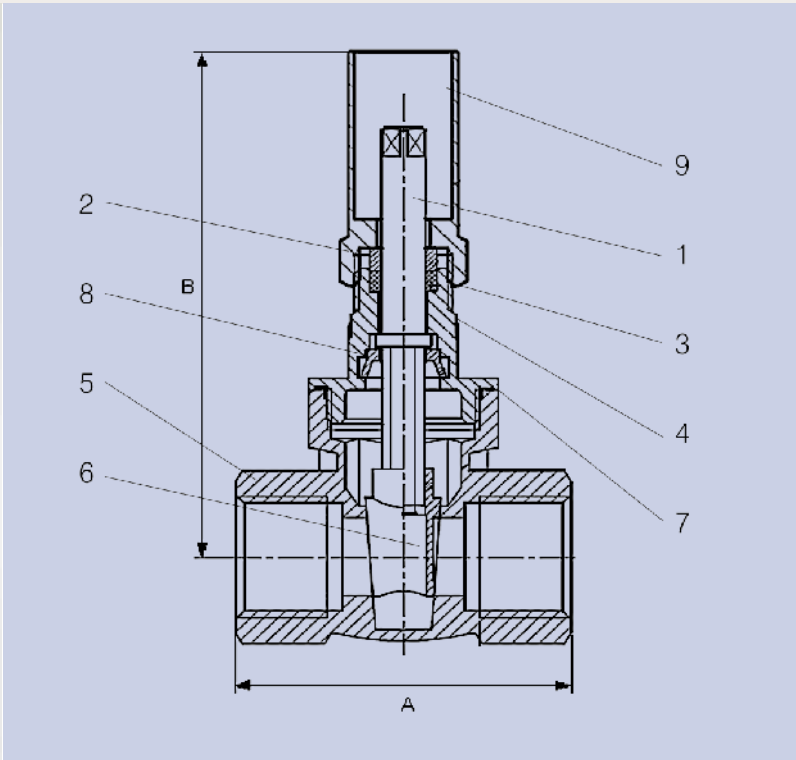

Features and benefits:

- Kitemark approved to EN 12288.
- Non-rising stem.
- Lockshield key operated.
- End connections, female taper threads to EN 10226-2 (ISO 7-1).
- Dezincification resistant brass prevents system corrosion and reduces fungal growth.
- WRAS approved for drinking water systems.
- Suitable for use with low temperature hot water and chilled systems.

Gate Valve - 1124

Order Code EN 10226-2 (ISO 7-1) taper thread	Size	DN	A	B	Kv Value	Weight (kg)
112450RRK200404	½"	15	55	85	16	0.26
112450RRK200606	¾"	20	60	95	32	0.40
112450RRK200808	1"	25	65	110	52	0.57
112450RRK201010	1¼"	32	75	125	100	0.96
112450RRK201212	1½"	40	80	145	172	1.13
112450RRK201616	2"	50	90	170	230	1.81
112450RRK202020*	2½"	65	100	210	-	3.68
112450RRK202424*	3"	80	115	240	-	5.42
112450RRK203232*	4"	100	135	290	-	10.59

\*Valves available to special order.

A--GVLKKEY-- Lockshield key for valves ½" to 1"

B--GVLKKEY-- Lockshield key for valves 1¼" to 2"

Valve suitability

Product	Steam	Water	Drinking Water	Oil	Air (Oil Free)	Gas (Inert)	Gas (Combustible)	Gas (Corrosive)	Gas (Oxygen)
1124	x	✓	✓	✓	x	x	x	x	x

Max. working parameters

1124	Temperature °C	Pressure bar	Pressure psi
Water	-10 to +100	20	290

Specification clauses:

- Kitemark approved to EN 12288.
- DZR brass Gate Valve.
- Non-rising stem.
- DZR threaded bonnet and one piece wedge.
- Lockshield key operated.
- End connections, female taper threads to EN 10226-2 (ISO 7-1).
- WRAS approved for drinking water systems.
- Suitable for low temperature hot water and chilled systems.

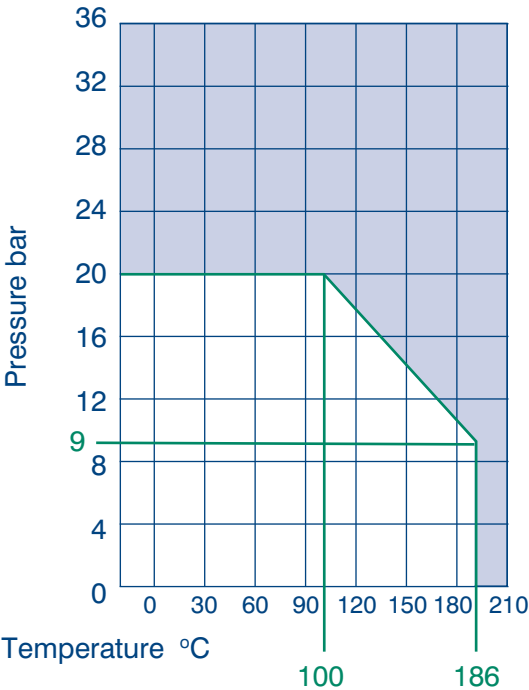

Valves range  
1124 Gate Valve Lockshield - PN20 - (DZR)

Material specification

Lockshield version: 1124- ½" - 4"

No	Component	Material	Specification
1	Stem	DZR Brass	EN 12164 CW602N
2	Packing Nut	Brass	EN 12164 CW614N
3	Packing	PTFE	PTFE
4	Bonnet	DZR Brass	EN 12165 CW602N
5	Body	DZR Brass	EN 12165 CW602N
6	Wedge	DZR Brass	EN 12165 CW602N
7	Seal	PTFE	PTFE
8	Stem Retainer	DZR Brass	EN 12164 CW602N
9	Lockshield	Brass	EN 12164 CW614N

Gate Valves are designed for services that only need infrequent operation, where the gate is maintained at either fully open or fully closed. They should not be used for throttling the flow of fluid.

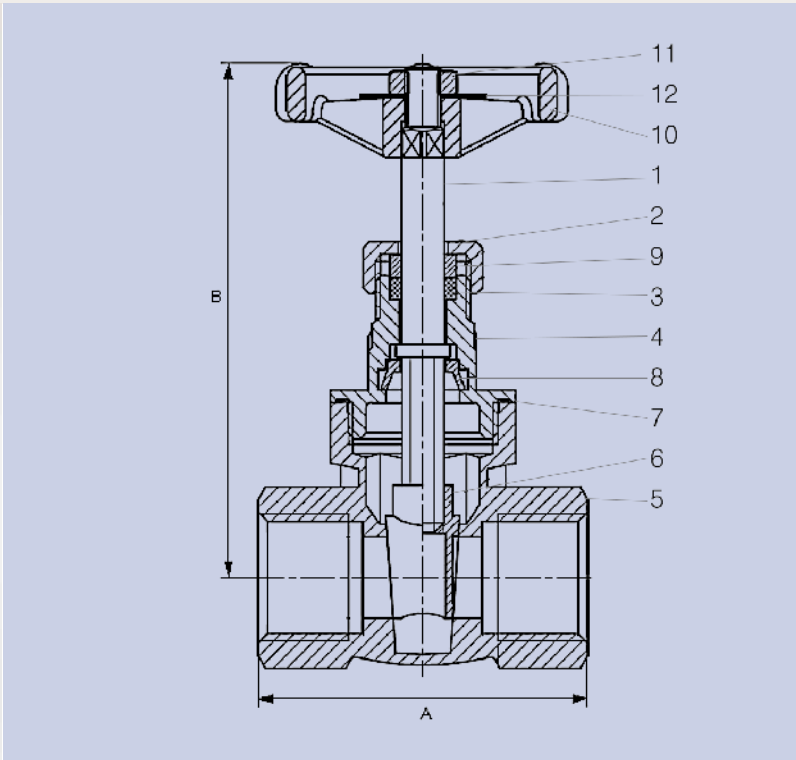

Features and benefits:

- Designed in accordance with EN 12288 requirements.
- High quality bronze construction immune to dezincification and stress corrosion cracking resistant.
- End connections, female taper threads to EN 10226-2 (ISO 7-1).
- WRAS approved for drinking water systems.
- Suitable for use with low temperature hot water and chilled systems.
- Unique Conex Bänninger handwheel.

Gate Valve - 1126

Order Code BS EN 10226-2 (ISO 7-1) thread	Size	DN	A	B	Kv Value	Weight (kg)
112620RRW320404	1/2"	15	55	85	16	0.36
112620RRW320606	3/4"	20	60	95	32	0.69
112620RRW320808	1"	25	70	115	52	1.02
112620RRW321010	1 1/4"	32	75	125	100	1.57
112620RRW321212	1 1/2"	40	80	145	172	2.44
112620RRW321616	2"	50	90	165	230	3.43
112620RRW322020*	2 1/2"	65	100	210	-	-
112620RRW322424*	3"	80	115	240	-	-
112620RRW323232*	4"	100	135	290	-	-

\*Valves available to special order

Valve suitability

Product	Steam	Water	Drinking Water	Oil	Air (Oil Free)	Gas (Inert)	Gas (Combustible)	Gas (Corrosive)	Gas (Oxygen)
1126	x	✓	✓	✓	x	x	x	x	x

Max. working parameters

1126	Temperature °C	Pressure bar	Pressure psi
Water	-10 to +100	32	460

Valves range

1126 Gate Valve Handwheel - PN32 - (Bronze)

Material specification

Handwheel version: 1126 - 1/2" - 4"

No	Component	Material	Specification
1	Stem	Bronze	EN 1982 CC491K
2	Packing Nut	Brass	EN 12164 CW614N
3	Packing	PTFE	PTFE
4	Bonnet	Bronze	EN 1982 CC491K
5	Body	Bronze	EN 1982 CC491K
6	Wedge	Bronze	EN 1982 CC491K
7	Seal	PTFE	PTFE
8	Stem Retainer	DZR Brass	EN 12164 CW602N
9	Packing Ring	Brass	EN 12164 CW614N
10	Handwheel	Aluminium	EN 1706 LM6
11	Handwheel Nut	Brass	EN 12164 CW614N
12	Identity Disc	Aluminium	EN 1706 LM6

Gate Valves are designed for services that only need infrequent operation, where the gate is maintained at either fully open or fully closed. They should not be used for throttling the flow of fluid.

Specification clauses:

- Bronze material in accordance with EN 1982.
- Designed in accordance to EN 12288 requirements.
- Handwheel operated.
- Non-rising stem.
- Bronze threaded bonnet and one piece wedge.
- End connections, taper threads designed to EN 10226-2 (ISO 7-1).
- WRAS approved for drinking water systems.
- Suitable for low temperature hot water and chilled systems.

